

REMOVAL AND INSTALLATION

Evaporative Emission Canister

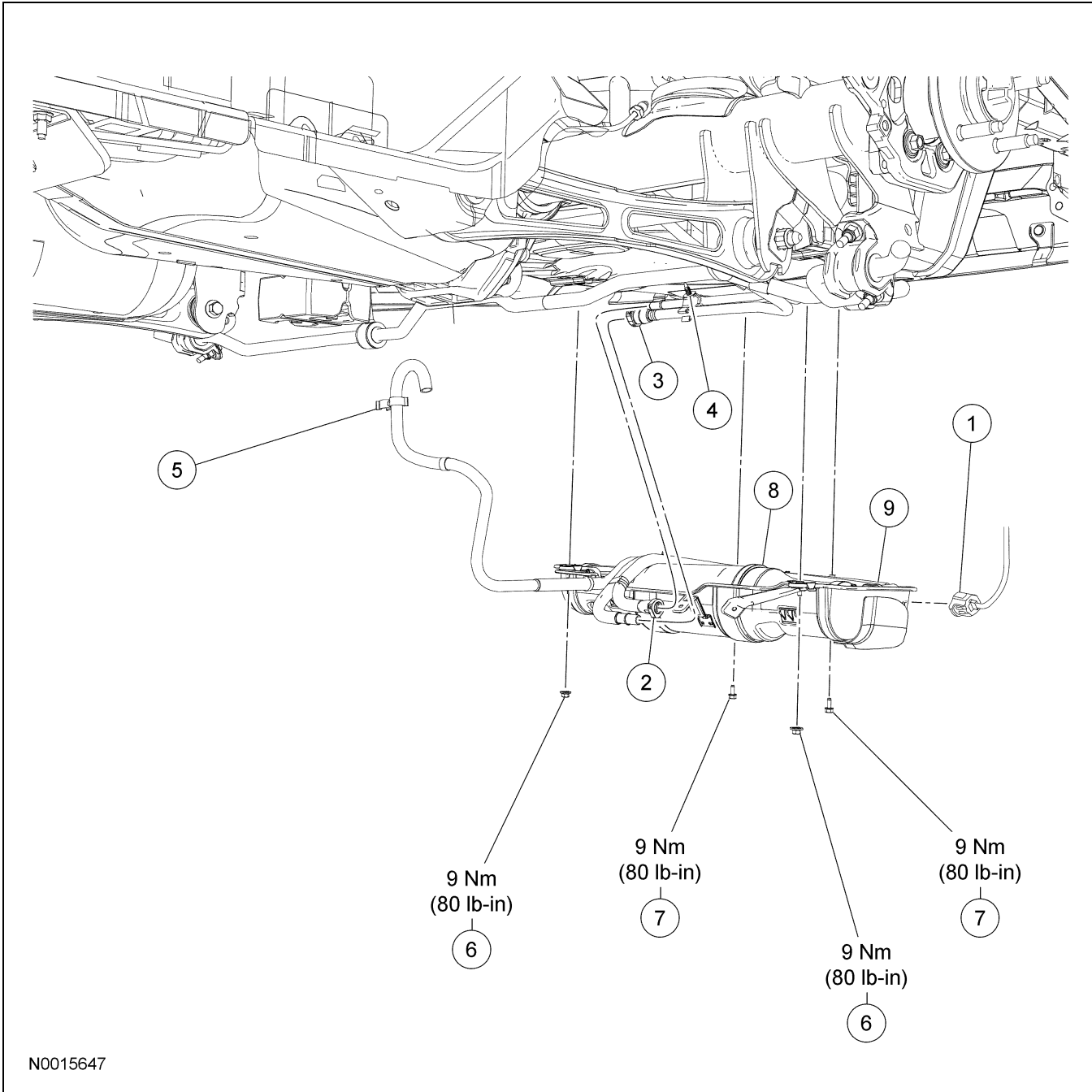

Item	Part Number	Description
1	14A464	Evaporative emission (EVAP) canister vent solenoid electrical connector
2	9K313	EVAP canister vapor tube quick connect coupling
3	9E325	Fuel vapor control tube quick connect coupling

(Continued)

Item	Part Number	Description
4	106463	Vapor tube pin-type retainer clip (2 required)
5	103435	Vapor tube retainer clip
6	N621906	EVAP canister retainer nuts (2 required)
7	N811181S	EVAP canister retainer bolts (2 required)

(Continued)

REMOVAL AND INSTALLATION (Continued)

Item	Part Number	Description
8	9D653	EVAP canister
9	9E857	EVAP canister assembly

Removal and Installation

⚠ WARNING: The evaporative emission system contains fuel vapor and condensed fuel vapor. Although not in large quantities, it still presents the danger of explosion or fire. Disconnect the battery ground cable from the battery to minimize the possibility of an electrical spark occurring, possibly causing a fire or explosion if fuel vapor or liquid fuel is present in the area. Failure to follow these instructions may result in personal injury.

⚠ WARNING: Do not smoke or carry lighted tobacco or open flame of any type when working on or near any fuel-related component. Highly flammable mixtures are always present and may be ignited. Failure to follow these instructions can result in personal injury.

⚠ WARNING: Do not carry personal electronic devices such as cell phones, pagers or audio equipment of any type when working on or near any fuel-related components. Highly flammable mixtures are always present and may be ignited. Failure to follow these instructions can result in personal injury.

1. With the vehicle in NEUTRAL, position it on a hoist. For additional information, refer to Section 100-02.
2. Disconnect the battery ground cable. For additional information, refer to Section 414-01.
3. Disconnect the evaporative emission (EVAP) canister vent solenoid electrical connector.
4. Disconnect the EVAP canister vapor tube quick connect coupling. For additional information, refer to Section 310-00.
5. Disconnect the fuel vapor control tube assembly valve quick connect coupling. For additional information, refer to Section 310-00.
6. If equipped, release the 2 vapor tube pin-type retainers from the EVAP canister brackets.
7. Release the vapor tube retainer clip and remove the vapor tube from the frame.
8. Remove the 2 EVAP canister retaining nuts.
 - To install, tighten to 9 Nm (80 lb-in).
9. Remove the 2 EVAP canister retaining bolts.
 - To install, tighten to 9 Nm (80 lb-in).
10. Remove the EVAP canister.
11. To install, reverse the removal procedure.
12. Carry out the evaporative emission system leak test. For additional information, refer to Evaporative Emission System Leak Test in this section.
13. Carry out the evaporative emission repair verification drive cycle. For additional information, refer to Evaporative Emission Repair Verification Drive Cycle in this section.